

John Wormley

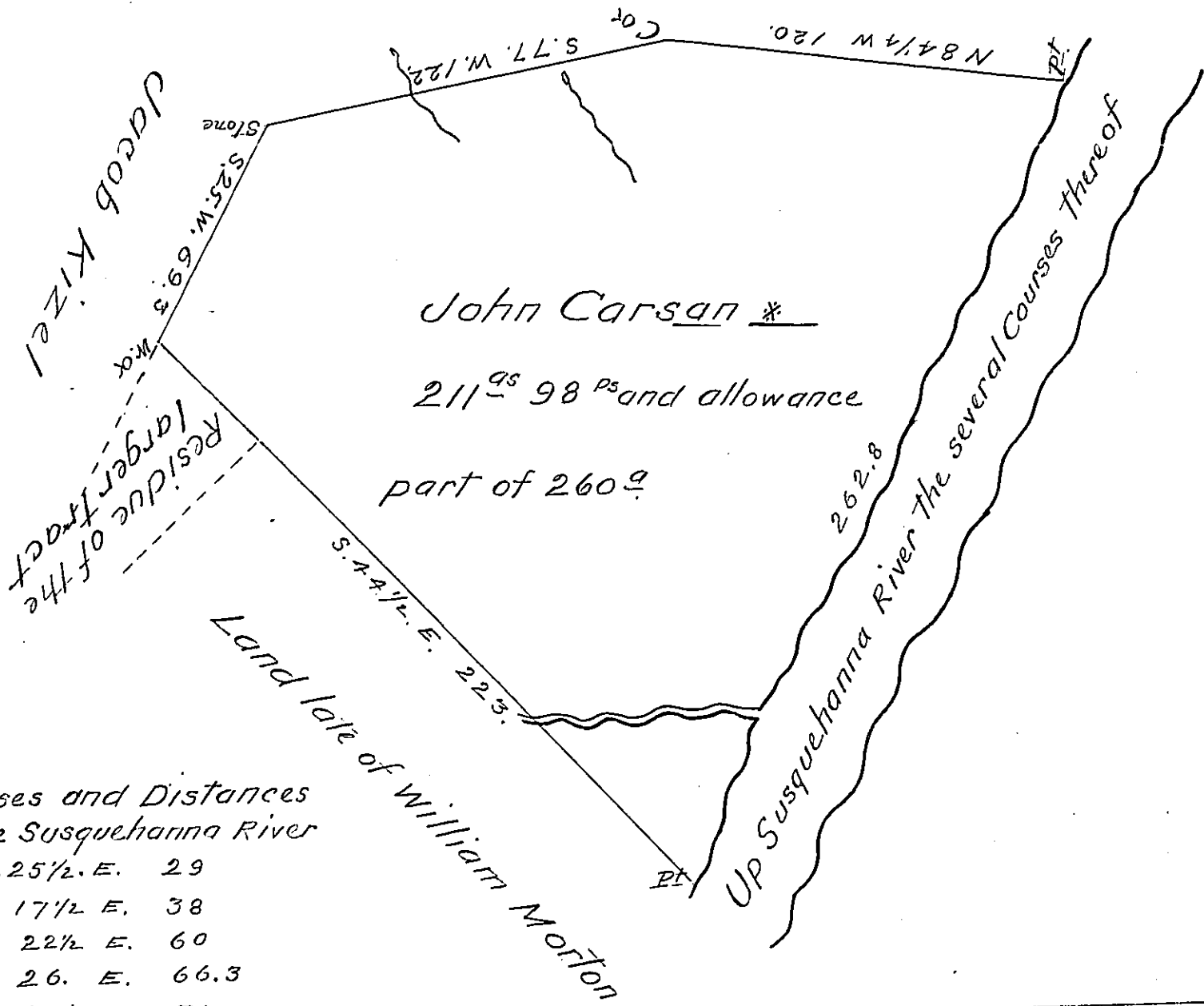

Courses and Distances  
up the Susquehanna River

N. 25 1/2. E.	29
N 17 1/2 E.	38
N 22 1/2 E.	60
N 26. E.	66.3
N 32 1/2 E.	31
N 29 E.	38.5
	<u>262.8</u>

A Draught of a Tract of Land situate in Eastpenns-  
borough Township Cumberland County Containing 211.<sup>98</sup>  
98 ps and allowance of six P Cent for Roads &c. It being  
part of a Larger tract of 260.<sup>98</sup> Surveyed in pursu-  
ance of a warrant granted to John Carson\* dated  
the 26<sup>th</sup> Day of October 1737. Resurveyed and Divided  
the 12<sup>th</sup> September 1809.

Wm. Wheeler D.S.

To Andrew Porter Esquire

S. G.

\* The Warrantee name is John Cassen not Carson.

IN TESTIMONY that the above is a copy of the original remaining on file in  
the Department of Internal Affairs of Pennsylvania, made  
conformably to an Act of Assembly approved the 16th day of  
February, 1833, I have hereunto set my Hand and caused  
the Seal of said Department to be affixed at Harrisburg,  
this sixteenth day of May 1904.

*George P. Brown*  
Secretary of Internal Affairs.